

# CliniLever® Basin/Sink Top Assembly

## PRODUCT CODES:

- |              |              |
|--------------|--------------|
| - TCBTC80CC  | - TCBTJ80CC  |
| - TCBTC80HC  | - TCBTJ80HC  |
| - TCBTC150CC | - TCBTJ150CC |
| - TCBTC150HC | - TCBTJ150HC |

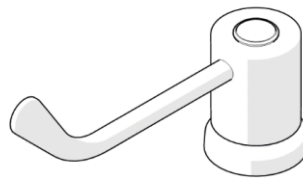

150mm Handle - SERIES

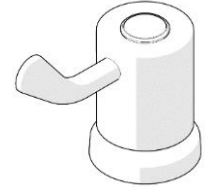

80mm Handle - SERIES

## SPECIFICATIONS

- The CliniLever® product range is primarily used for hand washing applications in hospitals, aged care facilities, schools and in-home care.
- Our highly sought after lever design is easily operated with elbows or wrist to avoid hand contact.
- Quick action SBA's includes brass jumper valve / ceramic cartridge component, with red or blue indicator button on 80mm or 150mm lever action handles.
- CliniLever Top Assemblies are designed to screw directly into any 15mm body to Australian Standards AS/NZS 3718.

**IMPORTANT:** All CliniLever® healthcare taps are tested in accordance with AS/NZS 3718 and leave our premises in good working order.

## TECHNICAL DATA

Inlet		5/8 BSP	
Outlet		N/A	
Headwork		Jumper Valve / Ceramic Disc	
Working Pressure Range (kPa)		Min	50
		Max	500
Working Temperature Range (°C)	Jumper Valve / Ceramic Disc	Min	5
	Jumper Valve / Ceramic Disc	Max	80
Construction		Brass	
Finish		Chrome	

**NOTE:** Galvin Engineering continually strive to improve their products. Specifications may change without notice.

## TOOLS REQUIRED

- Spanner or adjustable crescent

**PRE-INSTALLATION - MOUNTING DETAILS**

**Note:** Before installation, all lines must be flushed. We recommend that a line strainer be installed prior to top assembly to eliminate any foreign material.

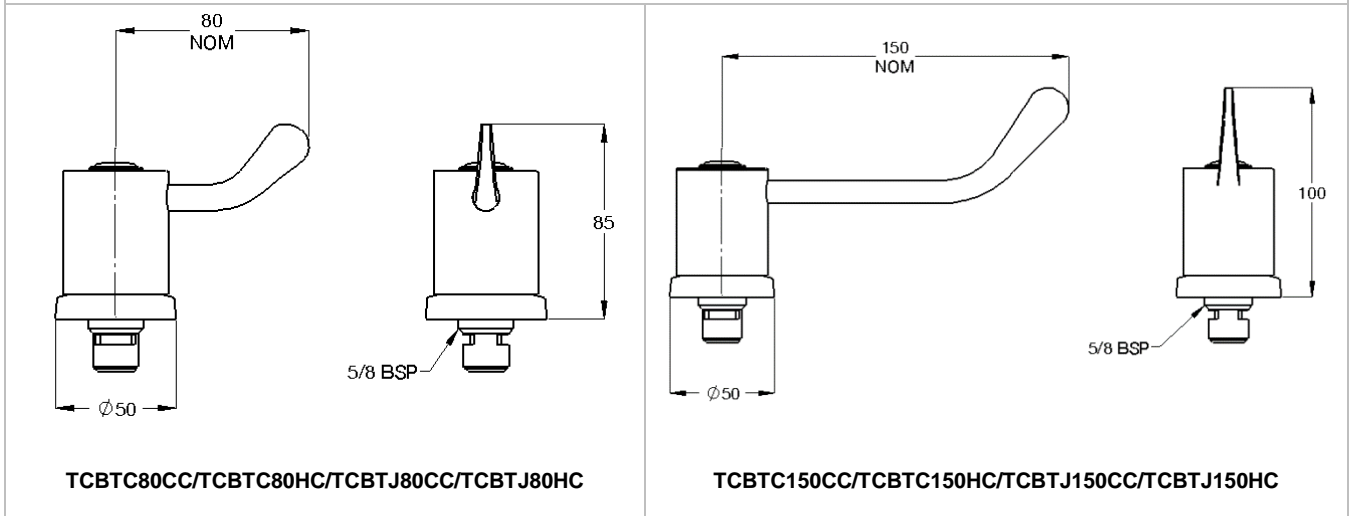

**INSTALLATION**

**IMPORTANT:** Galvin Engineering products must be installed in accordance with these installation instructions and in accordance with AS/NZS 3500, the PCA and your local regulatory requirements. Water and/or electrical supply conditions must also comply to the applicable National and/or State standards. Failing to comply with these provisions shall void the product warranty and may affect the performance of the product.

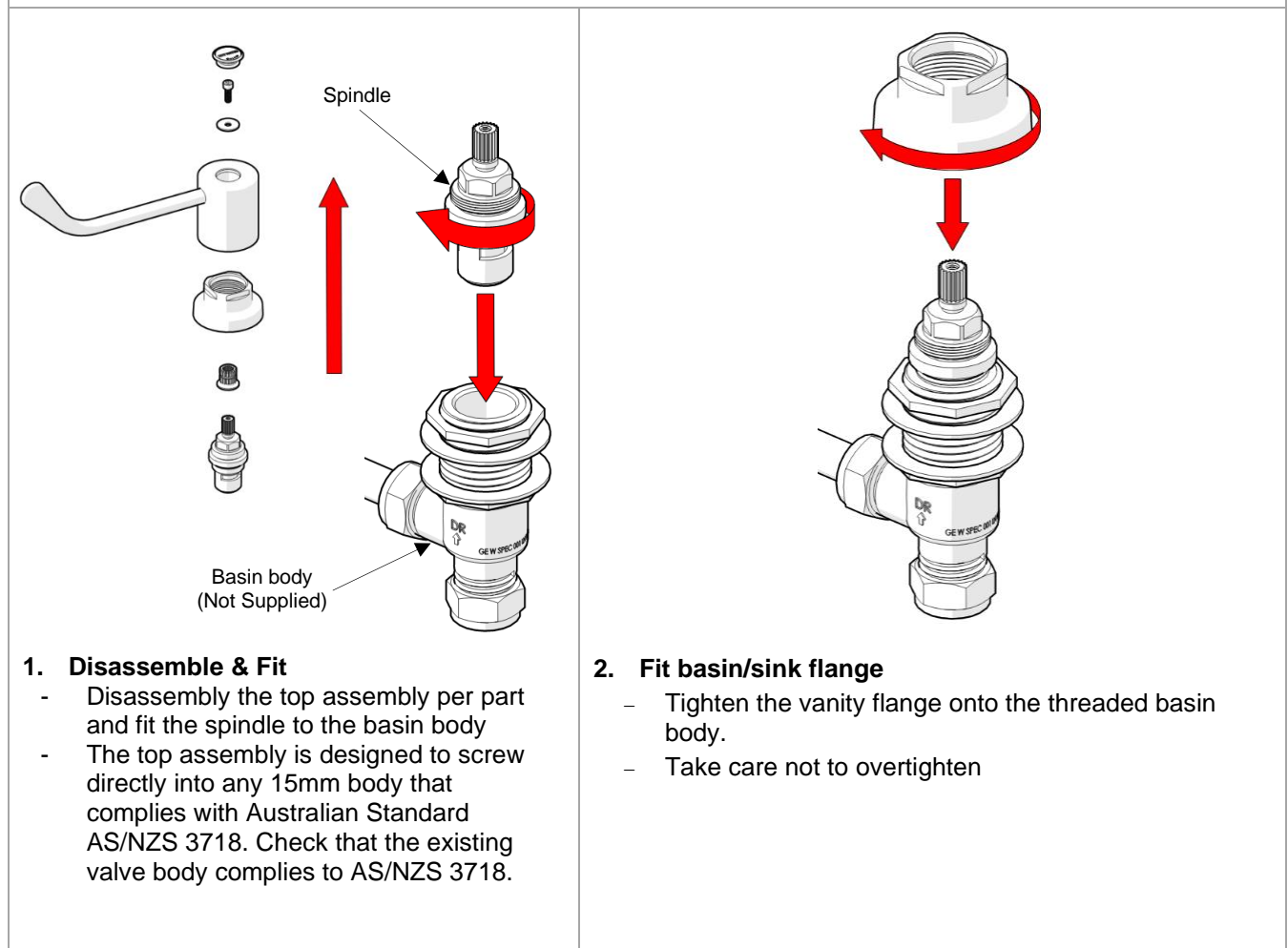

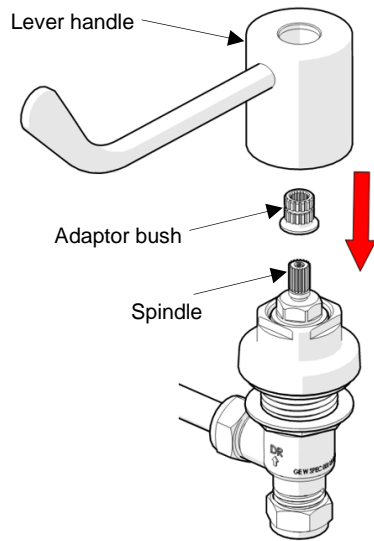

**3. Locate handle**

- Insert the adaptor bush onto the spindle
- When the spindle is in the closed position, firmly press the lever handle onto the spindle with levers facing forward.
- Check the handle operation. It should turn freely for a ¼ turn.

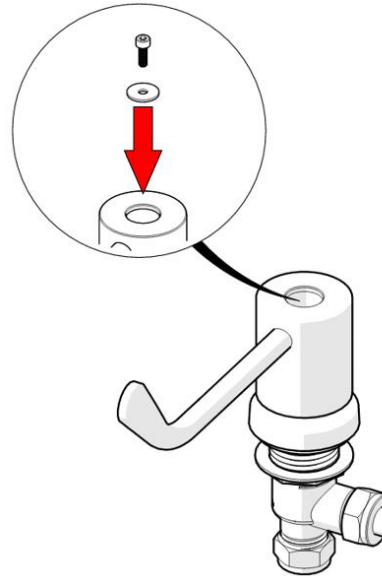

**4. Fit handle**

- Secure the handles in position using the supplied screws and washers.

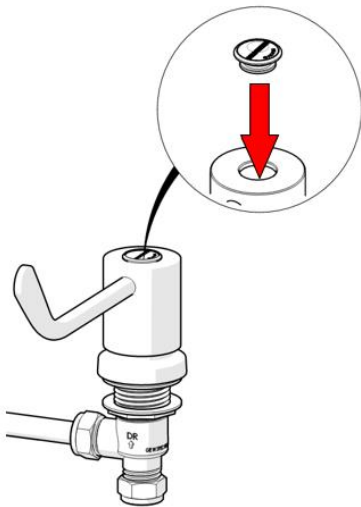

**5. Fit water temperature indicator & testing**

- Once the lever handles are secure, fit the appropriate water temperature indicators.
- Hot/warm on the left handle, cold on the right.
- Once secured, connect the hot and cold water.
- Open the lever handles and ensure that there is flow from both hot and cold inlets.
- Inspect the tap and check for any leaks.

<b>SERVICE AND MAINTENANCE</b>	
<b>JUMPER VALVE TAPWARE</b>	<b>CERAMIC CARTRIDGE TAPWARE</b>
<ol style="list-style-type: none"> <li>1. Turn off the water supply and turn on the tap handle to drain water from the bodies.</li> <li>2. Remove the temperature indicator from the handle.</li> <li>3. Remove the handle from the tap.</li> <li>4. Unscrew the top assembly from the body.</li> <li>5. Check the o-ring on the spindle and the jumper valve for wear and damage. Replace if required.</li> <li>6. Clean the spindle and body of debris.</li> <li>7. Place a new o-ring (if required) onto the spindle and re-grease with potable water approved grease.</li> <li>8. Re-assemble top assembly. Follow the product installation guidelines for the relevant product to re-assembly method.</li> </ol>	<ol style="list-style-type: none"> <li>1. Turn off the water supply and turn on the tap handle to drain water from the bodies.</li> <li>2. Remove the temperature indicator from the handle.</li> <li>3. Remove the handle from the tap.</li> <li>4. Unscrew the ceramic head part from the body.</li> <li>5. Check the o-ring on the ceramic head part for wear and damage. Replace if required.</li> <li>6. Clean the head part and the body of any debris.</li> <li>7. Replace the cartridge and screw tighten back into the body.</li> <li>8. Follow the product installation guidelines for the relevant product to re-assemble.</li> </ol>

<b>TROUBLESHOOTING</b>		
<b>PROBLEM</b>	<b>CAUSE</b>	<b>RECTIFICATION</b>
Taps are dripping water	Jumper valves are worn or damaged	Replace jumper valve
	Ceramic discs are worn or damaged	Remove and inspect SBA. Remove debris and/or replace SBA if damaged.
Water is leaking from spindle	O-ring on jumper valve spindle is damaged or worn	Replace o-ring
Spindle is difficult to turn (jumper valve)	Build up of scale on spindle, spindle worn or o-ring has been damaged	Remove jumper valve, clean and regrease. Replace o-ring. Complete SBA may need to be replaced.
Handle is loose	Screw has come loose	Tighten handle screw
Flange won't screw down onto basin/sink surface	Tap bodies are set too far out	Re-position tap bodies and breach piece

## WARRANTY

The warranty set forth herein is given expressly and is the only warranty given by the Galvin Engineering Pty Ltd. With respect to the product, Galvin Engineering Pty Ltd makes no other warranties, express or implied. Galvin Engineering Pty. Ltd. hereby specifically disclaims all other warranties, express or implied, including but not limited to the implied warranties of merchantability and fitness for a particular purpose.

Galvin Engineering Pty Ltd products are covered under our manufacturer's warranty available for download from [www.galvinengineering.com.au](http://www.galvinengineering.com.au) Galvin Engineering Pty Ltd expressly warrants that the product is free from operational defects in workmanship and materials for the warranty period as shown on the schedule in the manufacturer's warranty. During the warranty period, Galvin Engineering will replace or repair any defective products manufactured by Galvin Engineering without charge, so long as the terms of the Manufacturer's warranty are complied with.

The remedy described in the first paragraph of this warranty shall constitute the sole and exclusive remedy for breach of warranty, and Galvin Engineering Pty Ltd shall not be responsible for any incidental, special or consequential damages, including without limitation, lost profits or the cost of repairing or replacing other property which is damaged if this product does not work properly, other costs resulting from labour charges, delays, vandalism, negligence, fouling caused by foreign material, damage from adverse water conditions, chemical, electrical or any other circumstances over which Galvin Engineering has no control. This warranty shall be invalidated by any abuse, misuse, misapplication, improper installation or improper maintenance or alteration of the product.